

**FM EO2-功能螺母**

用于碳钢钢管

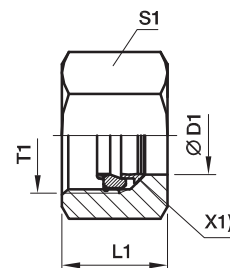

X1) 卡套

系列	D1 	T1	L1	S1	碳钢		碳钢		重量 克/件
					密封 NBR	工作压力 (bar)	密封 FKM	工作压力 (bar)	
LL	04	M8×1	11.0	10	<b>FM04LLCF</b>	—	—	—	5
	06	M10×1	11.5	12	—	—	—	—	6
L	06	M12×1.5	14.5	14	<b>FM06LCF</b>	500	<b>FM06LVITCF</b>	500	12
	08	M14×1.5	14.5	17	<b>FM08LCF</b>	500	<b>FM08LVITCF</b>	500	17
	10	M16×1.5	15.5	19	<b>FM10LCF</b>	500	<b>FM10LVITCF</b>	500	22
	12	M18×1.5	15.5	22	<b>FM12LCF</b>	400	<b>FM12LVITCF</b>	400	30
	15	M22×1.5	17.0	27	<b>FM15LCF</b>	400	<b>FM15LVITCF</b>	400	48
	18	M26×1.5	18.0	32	<b>FM18LCF</b>	400	<b>FM18LVITCF</b>	400	70
	22	M30×2	20.0	36	<b>FM22LCF</b>	250	<b>FM22LVITCF</b>	250	94
	28	M36×2	21.0	41	<b>FM28LCF</b>	250	<b>FM28LVITCF</b>	250	106
	35	M45×2	24.0	50	<b>FM35LCF</b>	250	<b>FM35LVITCF</b>	250	160
	42	M52×2	24.0	60	<b>FM42LCF</b>	250	<b>FM42LVITCF</b>	250	244
S	06	M14×1.5	16.5	17	<b>FM06SCF</b>	800	<b>FM06SVITCF</b>	800	20
	08	M16×1.5	16.5	19	<b>FM08SCF</b>	800	<b>FM08SVITCF</b>	800	23
	10	M18×1.5	17.5	22	<b>FM10SCF</b>	800	<b>FM10SVITCF</b>	800	37
	12	M20×1.5	17.5	24	<b>FM12SCF</b>	630	<b>FM12SVITCF</b>	630	39
	14	M22×1.5	20.5	27	<b>FM14SCF</b>	630	<b>FM14SVITCF</b>	630	60
	16	M24×1.5	20.5	30	<b>FM16SCF</b>	630	<b>FM16SVITCF</b>	630	72
	20	M30×2	24.0	36	<b>FM20SCF</b>	420	<b>FM20SVITCF</b>	420	121
	25	M36×2	27.0	46	<b>FM25SCF</b>	420	<b>FM25SVITCF</b>	420	221
	30	M42×2	29.0	50	<b>FM30SCF</b>	420	<b>FM30SVITCF</b>	420	248
	38	M52×2	32.5	60	<b>FM38SCF</b>	420	<b>FM38SVITCF</b>	420	367