

VW1 (超高压系列)

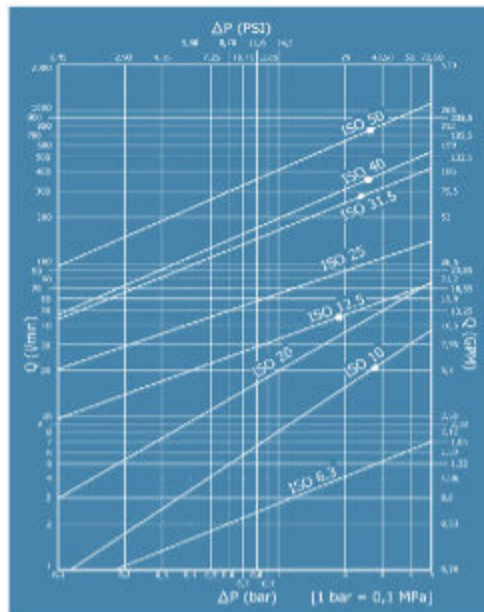

TECHNICAL INFORMATION
Materials: carbon and special steel zinc-plated and yellow bichromated.
Seals: standard in nitrile NBR. Other seals on request. **Working temperatures:** with NBR standard seals -25°C +125°C.
Back-up ring: in pure Teflon. **Working pressure:** 700 bar max.

技术信息
材料: 高压镀锌和白铬的特种钢。
关闭球体为一级优质UNI 100CR6。密封圈: 丁腈橡胶NBR。其他材质可依客户要求改为FPM或EPDM。工作温度: 丁腈橡胶NBR密封圈-25°C+125°C。支撑圈: 纯铁氟龙。工作压力: 210bar-900bar。

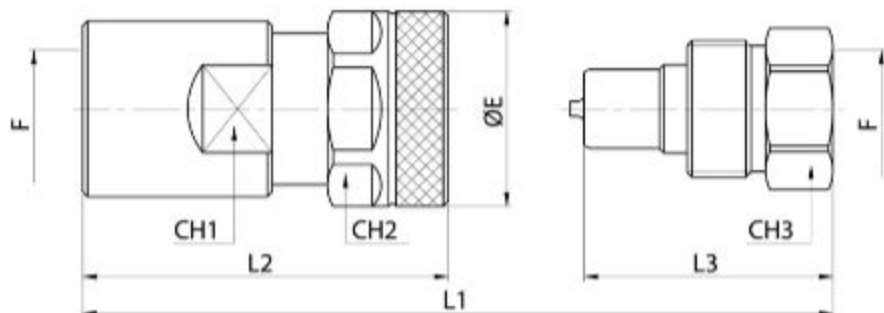

规格	标准	母头			公头		
		COD. F 母头型号	Weight (g) 重量(g)	Packaging (pcs.) 包装(pcs.)	COD. M 公头型号	Weight (g) 重量(g)	Packaging (pcs.) 包装(pcs.)
BSP 3/8"	DIN 3852-2-X	VW1.1010.002	344	24	VW1.1010.003	155	42
NPT 3/8"	ANSI B1.20.3	VW1.1010.012	346	24	VW1.1010.013	157	42
BSP 1/2"	DIN 3852-2-X	VW1.1313.002	576	20	VW1.1313.003	177	35
NPT 1/2"	ANSI B1.20.3	VW1.1313.012	582	20	VW1.1313.013	180	35
BSP 3/4"	DIN 3852-2-X	VW1.2019.002	988	15	VW1.2019.003	364	20
NPT 3/4"	ANSI B1.20.3	VW1.2019.012	997	15	VW1.2019.013	373	20
BSP 1"	DIN 3852-2-X	VW1.2525.002	1465	12	VW1.2525.003	524	15
NPT 1"	ANSI B1.20.3	VW1.2525.012	1481	12	VW1.2525.013	540	15
BSP 1 1/4"	DIN 3852-2-X	VW1.3031.002	2933	8	VW1.3031.003	1074	10
NPT 1 1/4"	ANSI B1.20.3	VW1.3031.012	2950	8	VW1.3031.013	1092	10
BSP 1 1/2"	DIN 3852-2-X	VW1.3939.002	4550	5	VW1.3939.003	1734	6
NPT 1 1/2"	ANSI B1.20.3	VW1.3939.012	4567	5	VW1.3939.013	1750	6
BSP 2"	DIN 3852-2-X	VW1.5051.002	8880	3	VW1.5051.003	5030	3
NPT 2"	ANSI B1.20.3	VW1.5051.012	8920	3	VW1.5051.013	5070	3

技术参数

规格	最大工作压力	流量	最小爆破压力			液体溢出量
			公头	母头	接口	
DNP BG USA ISO	DN (mm)	(bar)	(l/min)	(bar)	(bar)	(cc)
10 2 06 10	6.2	850	23-38	3000	3000	1.9
13 3 08 12.5	9	800	45-70	2500	2700	2.7
20 4 12 20	11	500	108-110	2400	2800	9.3
25 5 16 25	13.3	480	189-189	2300	2800	16
30 6 20 31.5	22.2	360	288-360	1500	1500	30
39 7 24 40	24.6	360	378-780	1200	1500	54
50 8 32 50	30	210	757-1000	1300	1300	120

金属



规格	母头的参数				公头的参数				材料
	DNP	BG	ISO	型号(母头)	重量(g)	包装(pcs.)	型号(公头)	重量(g)	
10	2	10	S/WV.10202	57	80	S/WV.10203	41	80	铝
13	3	12.5	S/WV.13202	72	60	S/WV.13203	47	60	铝
20	4	19	S/WV.20202	136	40	S/WV.20203	117	50	铝
25	5	25	S/WV.25202	145	30	S/WV.25203	156	30	铝
30	6	31.5	S/WV.30202	180	20	S/WV.30203	172	20	铝
39	7	40	S/WV.39202	230	10	S/WV.39203	210	10	铝
50	8	50	S/WV.50202	300	5	S/WV.50203	270	5	铝