

GAI-R 直通内螺纹接头 – 英制螺纹

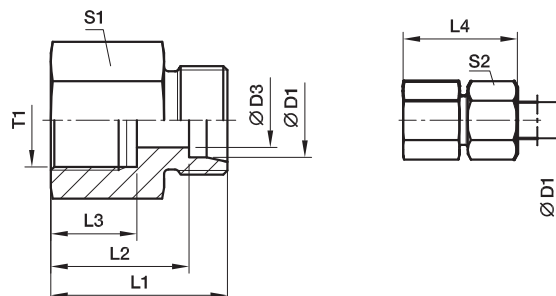

| 系列 | D1 | T1 | D3 | L1 | L2 | L3 | L4 | S1 | S2 | 重量 克/件 | 订货号* | 工作压力 (bar) | | |
|----|-------|-------|------|------|------|------|----|----|-----|----------------|-------------------|------------|-----|-----|
| | | | | | | | | | | | | CF | 71 | MS |
| L | 06 | G1/8 | 4 | 26.0 | 19.0 | 12.0 | 34 | 14 | 14 | 18 | GAI06LR | 315 | 315 | 200 |
| | 06 | G1/4 | 4 | 31.0 | 24.0 | 17.0 | 39 | 19 | 14 | 39 | GAI06LR1/4 | 315 | 315 | 200 |
| | 08 | G1/4 | 6 | 31.0 | 24.0 | 17.0 | 39 | 19 | 17 | 39 | GAI08LR | 315 | 315 | 200 |
| | 08 | G3/8 | 6 | 32.0 | 25.0 | 17.0 | 40 | 24 | 17 | 61 | GAI08LR3/8 | 315 | 315 | 200 |
| | 08 | G1/2 | 6 | 36.0 | 29.0 | 20.0 | 44 | 27 | 17 | 80 | GAI08LR1/2 | 315 | 315 | 200 |
| | 10 | G1/4 | 8 | 32.0 | 25.0 | 17.0 | 40 | 19 | 19 | 40 | GAI10LR | 315 | 315 | 200 |
| | 10 | G3/8 | 8 | 33.0 | 26.0 | 17.0 | 41 | 24 | 19 | 63 | GAI10LR3/8 | 315 | 315 | 200 |
| | 10 | G1/2 | 8 | 37.0 | 30.0 | 20.0 | 45 | 27 | 19 | 81 | GAI10LR1/2 | 315 | 315 | 200 |
| | 12 | G3/8 | 10 | 33.0 | 26.0 | 17.0 | 41 | 24 | 22 | 64 | GAI12LR | 315 | 315 | 200 |
| | 12 | G1/2 | 10 | 37.0 | 30.0 | 20.0 | 45 | 27 | 22 | 83 | GAI12LR1/2 | 315 | 315 | 200 |
| | 15 | G1/2 | 12 | 38.0 | 31.0 | 20.0 | 46 | 27 | 27 | 87 | GAI15LR | 315 | 315 | 200 |
| | 18 | G1/2 | 15 | 38.0 | 30.5 | 20.0 | 47 | 27 | 32 | 89 | GAI18LR | 315 | 315 | 200 |
| | 18 | G3/8 | 15 | 34.0 | 26.5 | 17.0 | 43 | 27 | 32 | 95 | GAI18LR3/8 | 315 | 315 | 200 |
| | 22 | G3/4 | 19 | 43.0 | 35.5 | 22.0 | 52 | 36 | 36 | 173 | GAI22LR | 160 | 160 | 100 |
| | 28 | G1 | 24 | 45.5 | 38.0 | 24.5 | 55 | 41 | 41 | 211 | GAI28LR | 160 | 160 | 100 |
| | 35 | G11/4 | 30 | 51.5 | 41.0 | 26.5 | 63 | 55 | 50 | 469 | GAI35LR | 160 | 160 | 100 |
| 42 | G11/2 | 36 | 53.5 | 42.5 | 28.5 | 65 | 60 | 60 | 540 | GAI42LR | 160 | 160 | 100 | |
| S | 06 | G1/4 | 4 | 33.0 | 26.0 | 17.0 | 41 | 19 | 17 | 43 | GAI06SR | 400 | 400 | |
| | 08 | G1/4 | 5 | 33.0 | 26.0 | 17.0 | 41 | 19 | 19 | 47 | GAI08SR | 400 | 400 | |
| | 10 | G3/8 | 7 | 34.0 | 26.5 | 17.0 | 43 | 24 | 22 | 68 | GAI10SR | 400 | 400 | |
| | 12 | G3/8 | 8 | 34.0 | 26.5 | 17.0 | 43 | 24 | 24 | 71 | GAI12SR | 400 | 400 | |
| | 12 | G1/2 | 8 | 38.0 | 30.5 | 20.0 | 47 | 30 | 24 | 121 | GAI12SR1/2 | 400 | 400 | |
| | 14 | G1/2 | 10 | 40.0 | 32.0 | 20.0 | 50 | 30 | 27 | 125 | GAI14SR | 400 | 400 | |
| | 16 | G1/2 | 12 | 40.0 | 31.5 | 20.0 | 50 | 30 | 30 | 126 | GAI16SR | 400 | 400 | |
| | 20 | G3/4 | 16 | 45.0 | 34.5 | 22.0 | 56 | 36 | 36 | 196 | GAI20SR | 315 | 315 | |
| | 25 | G1 | 20 | 49.5 | 37.5 | 24.5 | 62 | 41 | 46 | 246 | GAI25SR | 315 | 315 | |
| | 30 | G11/4 | 25 | 55.5 | 42.0 | 26.5 | 69 | 55 | 50 | 537 | GAI30SR | 315 | 315 | |
| | 38 | G11/2 | 32 | 59.5 | 43.5 | 28.5 | 74 | 60 | 60 | 649 | GAI38SR | 250 | 250 | |

* 不含螺母及卡套，总成型号及不同密封材料的货号参考D6页。

请根据
表面处理及
材料添加后缀

| 订货号后缀 | | |
|-----------|-------------|------------|
| 材料 | 表面处理 及材料 | 示例 |
| 碳钢，无六价铬镀锌 | CF | GAI16SRCFX |
| 不锈钢 | 71 | GAI16SR71X |
| 黄铜 | MS | GAI16SRMSX |