

GE-R 端直通接头 – 英制螺纹金属面密封

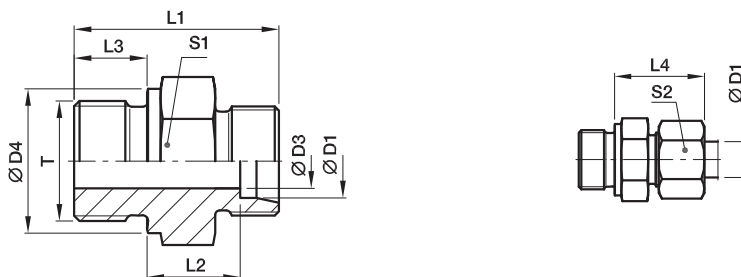

系列	D1	T	D3	D4	L1	L2	L3	L4	S1	S2	重量 克/件	订货号*	工作压力 (bar)		
													CF	71	MS
S	06	G1/4A	4	18	32.0	13.0	12	28	19	17	35	<b>GE06SR</b>	400	400	250
	06	G1/8A	3	14	27.5	12.5	8	27	14	17	22	<b>GE06SR1/8</b>	400	400	
	06	G3/8A	4	22	34.5	15.5	12	30	22	17	57	<b>GE06SR3/8</b>	400	400	
	06	G1/2A	4	26	39.0	18.0	14	33	27	17	83	<b>GE06SR1/2</b>	400	400	
	08	G1/4A	5	18	34.0	15.0	12	30	19	19	41	<b>GE08SR</b>	400	400	250
	08	G3/8A	5	22	34.5	15.5	12	30	22	19	59	<b>GE08SR3/8</b>	400	400	
	08	G1/2A	5	26	39.0	18.0	14	33	27	19	100	<b>GE08SR1/2</b>	400	400	
	10	G3/8A	7	22	34.5	15.0	12	31	22	22	56	<b>GE10SR</b>	400	400	250
	10	G1/4A	5	18	34.0	14.5	12	31	19	22	43	<b>GE10SR1/4</b>	400	400	
	10	G1/2A	7	26	39.0	17.5	14	34	27	22	97	<b>GE10SR1/2</b>	400	400	
	12	G3/8A	8	22	36.5	17.0	12	33	22	24	62	<b>GE12SR</b>	400	400	250
	12	G1/4A	5	18	36.0	16.5	12	33	22	24	57	<b>GE12SR1/4</b>	400	400	
	12	G1/2A	8	26	39.0	17.5	14	34	27	24	57	<b>GE12SR1/2</b>	400	400	
	14	G1/2A	10	26	41.0	19.0	14	37	27	27	96	<b>GE14SR</b>	400	400	250
	14	G3/8A	8	22	38.5	18.5	12	36	24	27	74	<b>GE14SR3/8</b>	400	400	
	16	G1/2A	12	26	41.0	18.5	14	37	27	30	92	<b>GE16SR</b>	400	400	250
	16	G3/8A	8	22	38.5	18.0	12	36	27	30	83	<b>GE16SR3/8</b>	400	400	
	16	G3/4A	12	32	45.0	20.5	16	39	32	30	157	<b>GE16SR3/4</b>	400	400	
	20	G3/4A	16	32	47.0	20.5	16	42	32	36	151	<b>GE20SR</b>	400	400	250
	20	G1/2A	12	26	45.0	20.5	14	42	32	36	142	<b>GE20SR1/2</b>	400	400	
	20	G1A	16	39	51.0	22.5	18	44	41	36	273	<b>GE20SR1</b>	250	250	
	20	G11/4A	16	49	53.0	22.5	20	44	50	36	387	<b>GE20SR11/4</b>	160	160	
	25	G1A	20	39	53.0	23.0	18	47	41	46	267	<b>GE25SR</b>	250	250	160
	25	G3/4A	16	32	51.0	23.0	16	47	41	46	245	<b>GE25SR3/4</b>	250	250	
	25	G11/4A	20	49	55.0	23.0	20	47	50	46	422	<b>GE25SR11/4</b>	160	160	
	30	G11/4A	25	49	57.0	23.5	20	50	50	50	422	<b>GE30SR</b>	160	160	100
	30	G1A	20	39	55.0	23.5	18	50	46	50	337	<b>GE30SR1</b>	160	160	
	38	G11/2A	32	55	64.0	26.0	22	57	55	60	560	<b>GE38SR</b>	160	160	100
38	G11/4A	25	49	62.0	26.0	20	57	55	60	578	<b>GE38SR11/4</b>	160	160		

\* 不含螺母及卡套，总成型号及不同密封材料的货号参考D6页。

请根据  
表面处理及  
材料添加后缀

订货号后缀		
材料	表面处理 及材料	示例
碳钢, 无六价铬镀锌	CF	GE16SRCFX
不锈钢	71	GE16SR71X
黄铜	MS	GE16SRMSX